



TRANSPORTATION CABINET

Frankfort, Kentucky 40622
www.transportation.ky.gov/

Steven L. Beshear
Governor

Michael W. Hancock, P.E.
Secretary

June 6, 2013

CALL NO. 200
CONTRACT ID NO. 131033
ADDENDUM # 3

Subject: Nelson-Washington Counties, 121GR13D033-NHPP BRO
Letting June 14, 2013

- (1) Revised - Plan Sheets - R2B & R9
- (2) Revised - CAP Note - Page 19 of 51

Proposal revisions are available at <http://transportation.ky.gov/Construction-Procurement/>.

If you have any questions, please contact us at 502-564-3500.

Sincerely,

A handwritten signature in blue ink that reads "Ryan Griffith".

Ryan Griffith
Acting Director
Division of Construction Procurement

RG:ks
Enclosures



An Equal Opportunity Employer M/F/D

COUNTY OF	ITEM NO.	SHEET NO.
NELSON WASHINGTON	4+1079	R2B

GENERAL NOTES

CONVENTIONAL SIGNS

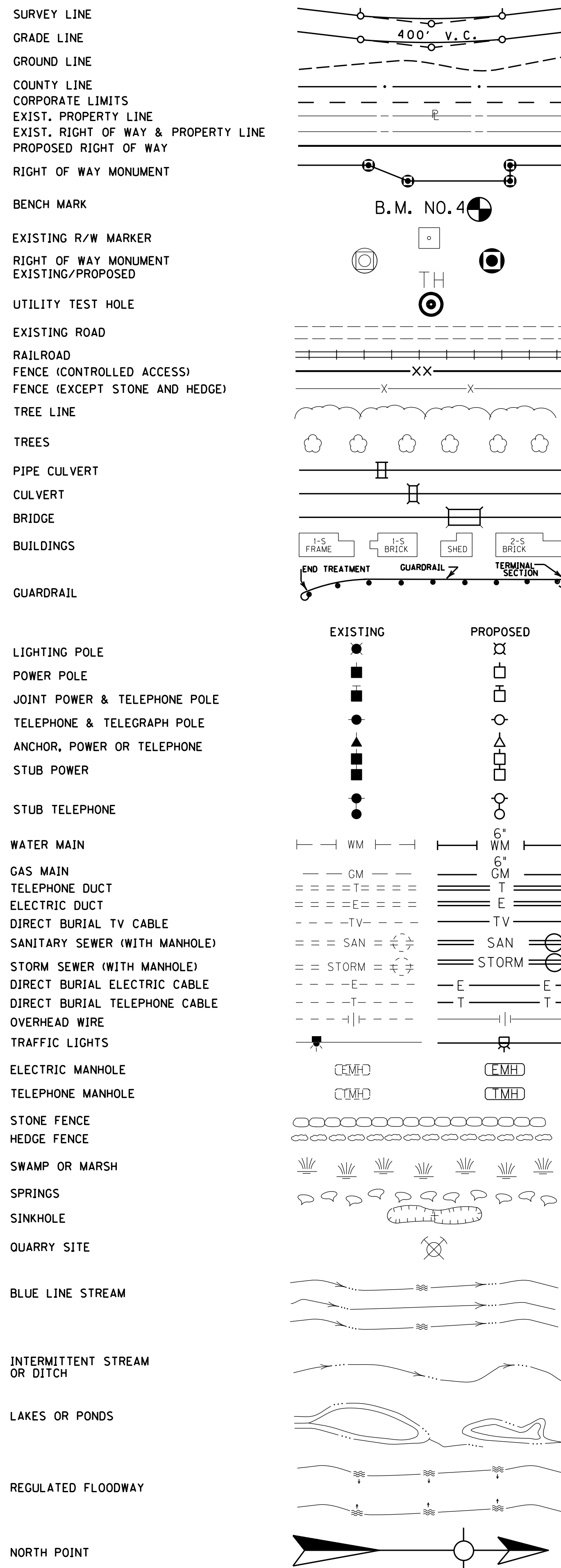

165 BEFORE YOU DIG

THE CONTRACTOR IS INSTRUCTED TO CALL 1-800-752-6007 TO REACH KY 811, THE ONE-CALL SYSTEM FOR INFORMATION ON THE LOCATION OF EXISTING UNDERGROUND UTILITIES. THE CALL IS TO BE PLACED A MINIMUM OF TWO (2) AND NO MORE THAN TEN (10) BUSINESS DAYS PRIOR TO EXCAVATION. THE CONTRACTOR SHOULD BE AWARE THAT OWNERS OF UNDERGROUND FACILITIES ARE NOT REQUIRED TO BE MEMBERS OF THE KY 811 ONE-CALL BEFORE-U-DIG (BUD) SERVICE. THE CONTRACTOR MUST COORDINATE EXCAVATION WITH THE UTILITY OWNERS, INCLUDING THOSE WHOM DO NOT SUBSCRIBE TO KY 811. IT MAY BE NECESSARY FOR THE CONTRACTOR TO CONTACT THE COUNTY COURT CLERK TO DETERMINE WHAT UTILITY COMPANIES HAVE FACILITIES IN THE AREA.

190 DEPARTMENT OF THE ARMY PERMIT AND WATER QUALITY CERTIFICATION APPROVALS

A DEPARTMENT OF THE ARMY (DA) PERMIT, WHICH MAY REQUIRE APPROVAL OF A STATE WATER QUALITY CERTIFICATION FROM THE KENTUCKY DIVISION OF WATER, REGULATES THIS PROJECT AT ONE OR MORE LOCATIONS. PERFORM ALL APPLICABLE WORK IN COMPLIANCE WITH THE CONDITIONS STATED IN THE DA PERMIT AND THE APPROVED WATER QUALITY CERTIFICATION. POST A COPY OF THE DA PERMIT AND THE WATER QUALITY CERTIFICATION IN A CONSPICUOUS PLACE AT THE PROJECT SITE. IF A DA PERMIT OR WATER QUALITY CERTIFICATION APPROVAL IS PENDING, DO NOT WORK IN OR DISTURB THE DESIGNATED AREA(S) UNTIL OBTAINING THE APPROPRIATE APPROVAL(S). REFER TO NOTICE(S) CONTAINED IN THE CONTRACT BID PROPOSAL FOR DESIGNATED AREA(S) WHERE WORK IS PROHIBITED BY THE ABSENCE OF APPROVAL.

BAT MITIGATION

THE CONTRACTOR MUST NOTIFY JOSEPH FERGUSON, KYTC DISTRICT ENVIRONMENTAL COORDINATOR, 10 BUSINESS DAYS (M-F) PRIOR TO START OF DEMOLITION AT 270-766-5066 OR JOSEPH.FERGUSON@KY.GOV

448 COMPACTION OF ASPHALT MIXTURES

WILL ACCEPT THE COMPACTION OF ASPHALT MIXTURES FURNISHED ON THIS PROJECT BY OPTION B ACCORDING TO SUBSECTIONS 402.03.02 AND 403.03.10 OF THE STANDARD SPECIFICATIONS.

455 EDGE KEY

THIS WORK INCLUDES CUTTING OUT THE EXISTING ASPHALT SURFACE TO A MINIMUM DEPTH AND WIDTH AS DETAILED ELSEWHERE IN THE PLANS SO THAT THE NEW SURFACE MAY HEEL INTO THE EXISTING SURFACE. THE CONTRACT UNIT PRICE BID LINEAR FOOT (PER METER) FOR "EDGE KEY" INCLUDES ALL NECESSARY MATERIALS, LABOR AND EQUIPMENT NECESSARY TO PERFORM THE WORK AND DISPOSE OF THE REMOVED ASPHALT MATERIAL.

650 STANDARD DRAWINGS

STANDARD DRAWINGS ARE NOT ATTACHED TO THESE PLANS. A STANDARD DRAWING BOOK AND THE HEADWALL SUPPLEMENTAL BOOK MAY BE OBTAINED FROM THE POLICY SUPPORT BRANCH OF THE DEPARTMENT OF ADMINISTRATIVE SERVICES IN FRANKFORT, KY. AT (502) 564-3670

DIVISION OF AIR QUALITY NOI

THE CONTRACTOR WILL BE RESONSIBLE FOR SUBMITTING A NOI (NOTICE OF INTENT) TO THE APPROPRIATE KENTUCKY DIVISION OF AIR QUALITY REGIONAL OFFICE AT LEAST 10 BUSINESS DAYS PRIOR TO DEMOLITION OF BRIDGE STRUCTURE.

UTILITY CONTACTS

TELEPHONE
AT&T
Mr. Morgan Herndon
3719 Bardstown Road
Louisville, KY 40218
502-458-7312

Salt River Electric
Wayne Hamilton
502-249-2081

NOT TO SCALE

DESIGNED BY: BEN HORNBACK, PE
DATE SUBMITTED: MARCH 6, 2013

Commonwealth of Kentucky
DEPARTMENT OF HIGHWAYS
COUNTY OF
NELSON
WASHINGTON

PROJECT: FD52 090 0458 001-001, FD52 1115 0458 006-007
NUMBERS: NHPP BRO 0403 (187)

GENERAL NOTES
KY 458

FILE NAME: G:\PWORK\BRADLEY_BOTTOMS.D0557394\RO0208GN.DGN

USER: ben.hornback
DATE PLOTTED: June 4, 2013

E-SHEET NAME:

MicroStation v8.11.7.443

GENERAL NOTES

CONVENTIONAL SIGNS

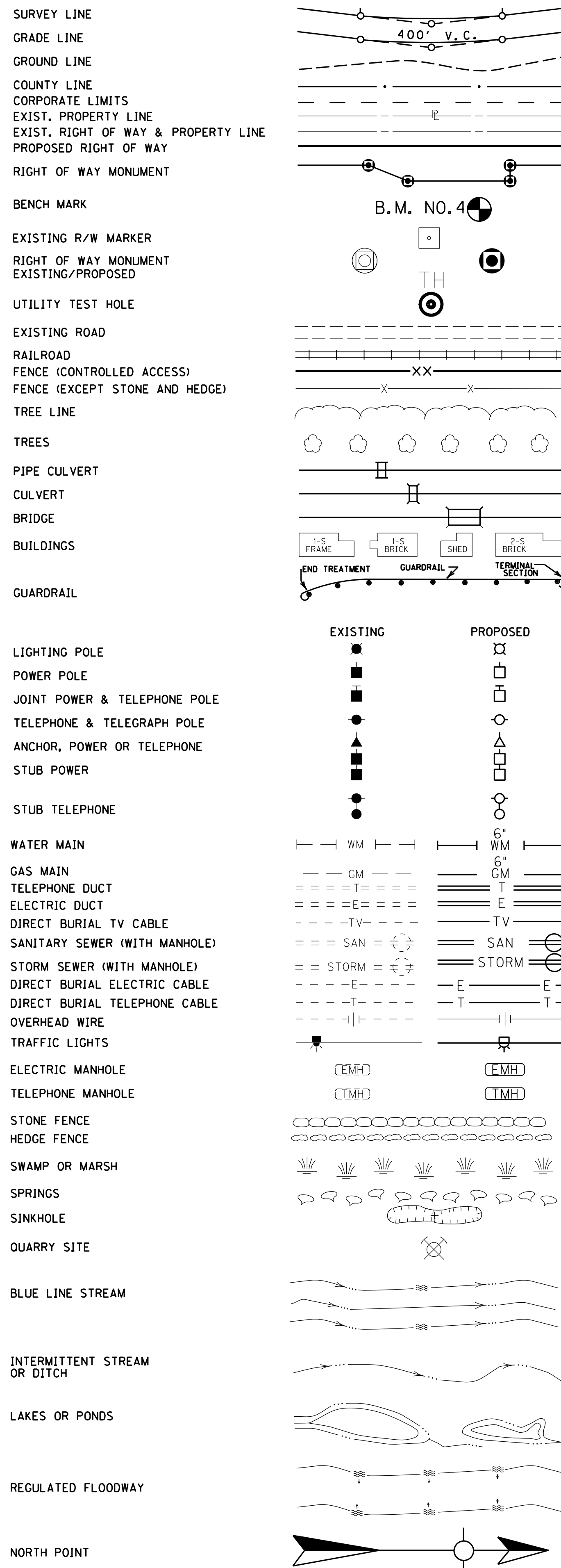

165 BEFORE YOU DIG

THE CONTRACTOR IS INSTRUCTED TO CALL 1-800-752-6007 TO REACH KY 811, THE ONE-CALL SYSTEM FOR INFORMATION ON THE LOCATION OF EXISTING UNDERGROUND UTILITIES. THE CALL IS TO BE PLACED A MINIMUM OF TWO (2) AND NO MORE THAN TEN (10) BUSINESS DAYS PRIOR TO EXCAVATION. THE CONTRACTOR SHOULD BE AWARE THAT OWNERS OF UNDERGROUND FACILITIES ARE NOT REQUIRED TO BE MEMBERS OF THE KY 811 ONE-CALL BEFORE-U-DIG (BUD) SERVICE. THE CONTRACTOR MUST COORDINATE EXCAVATION WITH THE UTILITY OWNERS, INCLUDING THOSE WHOM DO NOT SUBSCRIBE TO KY 811. IT MAY BE NECESSARY FOR THE CONTRACTOR TO CONTACT THE COUNTY COURT CLERK TO DETERMINE WHAT UTILITY COMPANIES HAVE FACILITIES IN THE AREA.

190 DEPARTMENT OF THE ARMY PERMIT AND WATER QUALITY CERTIFICATION APPROVALS

A DEPARTMENT OF THE ARMY (DA) PERMIT, WHICH MAY REQUIRE APPROVAL OF A STATE WATER QUALITY CERTIFICATION FROM THE KENTUCKY DIVISION OF WATER, REGULATES THIS PROJECT AT ONE OR MORE LOCATIONS. PERFORM ALL APPLICABLE WORK IN COMPLIANCE WITH THE CONDITIONS STATED IN THE DA PERMIT AND THE APPROVED WATER QUALITY CERTIFICATION. POST A COPY OF THE DA PERMIT AND THE WATER QUALITY CERTIFICATION IN A CONSPICUOUS PLACE AT THE PROJECT SITE. IF A DA PERMIT OR WATER QUALITY CERTIFICATION APPROVAL IS PENDING, DO NOT WORK IN OR DISTURB THE DESIGNATED AREA(S) UNTIL OBTAINING THE APPROPRIATE APPROVAL(S). REFER TO NOTICE(S) CONTAINED IN THE CONTRACT BID PROPOSAL FOR DESIGNATED AREA(S) WHERE WORK IS PROHIBITED BY THE ABSENCE OF APPROVAL.

BAT MITIGATION

THE CONTRACTOR MUST NOTIFY JOSEPH FERGUSON, KYTC DISTRICT ENVIRONMENTAL COORDINATOR, 10 BUSINESS DAYS (M-F) PRIOR TO START OF DEMOLITION AT 270-766-5066 OR JOSEPH.FERGUSON@KY.GOV

448 COMPACTION OF ASPHALT MIXTURES

WILL ACCEPT THE COMPACTION OF ASPHALT MIXTURES FURNISHED ON THIS PROJECT BY OPTION B ACCORDING TO SUBSECTIONS 402.03.02 AND 403.03.10 OF THE STANDARD SPECIFICATIONS.

455 EDGE KEY

THIS WORK INCLUDES CUTTING OUT THE EXISTING ASPHALT SURFACE TO A MINIMUM DEPTH AND WIDTH AS DETAILED ELSEWHERE IN THE PLANS SO THAT THE NEW SURFACE MAY HEEL INTO THE EXISTING SURFACE. THE CONTRACT UNIT PRICE BID LINEAR FOOT (PER METER) FOR "EDGE KEY" INCLUDES ALL NECESSARY MATERIALS, LABOR AND EQUIPMENT NECESSARY TO PERFORM THE WORK AND DISPOSE OF THE REMOVED ASPHALT MATERIAL.

650 STANDARD DRAWINGS

STANDARD DRAWINGS ARE NOT ATTACHED TO THESE PLANS. A STANDARD DRAWING BOOK AND THE HEADWALL SUPPLEMENTAL BOOK MAY BE OBTAINED FROM THE POLICY SUPPORT BRANCH OF THE DEPARTMENT OF ADMINISTRATIVE SERVICES IN FRANKFORT, KY. AT (502) 564-3670

DIVISION OF AIR QUALITY NOI

THE CONTRACTOR WILL BE RESONSIBLE FOR SUBMITTING A NOI (NOTICE OF INTENT) TO THE APPROPRIATE KENTUCKY DIVISION OF AIR QUALITY REGIONAL OFFICE AT LEAST 10 BUSINESS DAYS PRIOR TO DEMOLITION OF BRIDGE STRUCTURE.

UTILITY CONTACTS

TELEPHONE
AT&T
Mr. Morgan Herndon
3719 Bardstown Road
Louisville, KY 40218
502-458-7312

Salt River Electric
Wayne Hamilton
502-249-2081

NOT TO SCALE

DESIGNED BY: BEN HORNBACK, PE
DATE SUBMITTED: MARCH 6, 2013

Commonwealth of Kentucky
DEPARTMENT OF HIGHWAYS
COUNTY OF
NELSON
WASHINGTON

PROJECT: FD52 090 0458 001-001, FD52 1115 0458 006-007
NUMBERS: NHPP BRO 0403 (187)

GENERAL NOTES
KY 458

FILE NAME: G:\PWORK\BRADLEY_BOTTOMS.D0557394\RO0208GN.DGN

USER: ben.hornback
DATE PLOTTED: June 4, 2013

E-SHEET NAME:

MicroStation v8.11.7.443

EROSION CONTROL NOTES

COUNTY OF	ITEM NO.	SHEET NO.
Nelson Washington	4-1079	R9

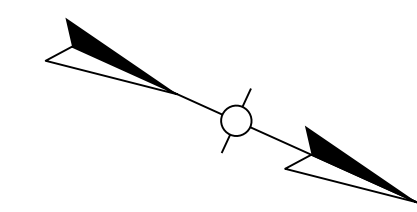

EROSION CONTROL LEGEND

SILT TRAP TYPE A ALTERNATE 1	
SILT TRAP TYPE A ALTERNATE 2	
SILT TRAP TYPE B	
SILT TRAP TYPE C	
SILT FENCE	
TEMPORARY SILT DITCH	
DISTURBED DRAINAGE AREA	
OVERLAND SHEET FLOW	
PROPOSED R/W	
PROPOSED EASEMENT	

ALL SILT CONTROL DEVICES SHALL BE SIZED TO RETAIN A VOLUME OF 3,600 CUBIC FEET PER DISTURBED CONTRIBUTING ACRE.

THE CONTRACTOR SHALL CONDUCT HIS OPERATIONS TO MINIMIZE THE AMOUNT OF DISTURBED GROUND DURING EACH PHASE OF CONSTRUCTION. THE CONTRACTOR SHALL COMPUTE THE VOLUME NECESSARY TO CONTROL SEDIMENT DURING EACH PHASE OF CONSTRUCTION. AS WORK PROCEEDS, SILT TRAPS MAY BE ADDED OR REMOVED IN ORDER TO ACHIEVE THE BEST MANAGEMENT PLAN. THE REQUIRED VOLUME AT EACH ADDED SILT TRAP SHALL BE COMPUTED AS UP GRADIENT CONTRIBUTING AREAS ARE DISTURBED OR ARE STABILIZED TO THE SATISFACTION OF THE ENGINEER. THE REQUIRED VOLUME CALCULATION FOR EACH SILT TRAP SHALL BE DETERMINED BY THE CONTRACTOR AND VERIFIED BY THE ENGINEER. THE REQUIRED VOLUME AT EACH SILT TRAP MAY BE REDUCED BY THE FOLLOWING AMOUNTS:

- UP GRADIENT AREAS NOT DISTURBED (ACRES).
- UP GRADIENT AREAS THAT HAVE BEEN RECLAIMED AND PROTECTED BY EROSION CONTROL BLANKET OR OTHER GROUND PROTECTION MATERIAL SUCH AS TEMPORARY MULCH (ACRES).
- THE USE OF TEMPORARY MULCH IS ENCOURAGED.
- UP GRADIENT AREAS THAT HAVE BEEN PROTECTED BY SILT FENCE (ACRES). AREAS PROTECTED BY SILT FENCE SHALL BE COMPUTED AT A MAXIMUM RATE OF 100 SQUARE FOOT PER LINEAR FOOT OF SILT FENCE.
- UP GRADIENT AREAS THAT HAVE BEEN PROTECTED BY SILT TRAPS (ACRES).

THE EROSION CONTROL PLAN SHALL BE ANNOTATED AS THE WORK PROCEEDS BY THE CONTRACTOR TO DETAIL THE SELECTION OF EACH EROSION CONTROL DEVICE USED AND THE VOLUME PROVIDED BY EACH SILT TRAP IN ACCORDANCE WITH THE DOCUMENTATION PROCEDURES ESTABLISHED BY THE DIVISION OF CONSTRUCTION.

IF A SILT BASIN IS NOT USED THEN ONE SILT TRAP TYPE A, ALTERNATE NUMBER 2 OR SILT TRAP TYPE B SHALL ALWAYS BE PLACED AT THE MOST REMOTE DOWNSTREAM COLLECTION POINT PRIOR TO DISCHARGING INTO A BLUE LINE STREAM OR ONTO AN ADJACENT PROPERTY OWNER. WHERE OVERLAND FLOW EXISTS, A SILT FENCE OR OTHER FILTER DEVICES MAY BE USED OR THE OVERLAND FLOW MAY BE DIVERTED TO ONE OF THE AFOREMENTED SILT BASIN OR TRAPS.

THE EROSION CONTROL PLANS DO NOT CONSTITUTE A BMP BY THEMSELVES. THEY PROVIDE A STARTING POINT FOR THE CONTRACTOR AND SECTION ENGINEER TO DEVELOP THE BMP ACCORDING TO SECTION 213.03.01 OF THE STANDARD SPECIFICATIONS FOR ROAD AND BRIDGE CONSTRUCTION, AND THE SUPPLEMENTAL SPECS EFFECTIVE WITH THE OCTOBER, 2004 LETTING.

EROSION CONTROL MEASURES SHALL BE IN PLACE AND FUNCTIONING PRIOR TO ANY EXCAVATION OR DISTURBANCE WITHIN A DRAINAGE AREA.

THE CONTRACTOR SHALL BE REQUIRED TO CLEAN OUT (REMOVE SEDIMENT FROM) SILT TRAPS AND SILT FENCES WHENEVER THEY BECOME ONE-HALF FULL AND PROPERLY DISPOSE OF THE MATERIAL AT SITES APPROVED BY THE SECTION ENGINEER.

EROSION CONTROL MEASURES EMPLOYED BY THE CONTRACTOR WILL BE UNIQUE TO THE PROJECT AND WORK CONDITIONS AND SHALL BE APPROVED BY THE SECTION ENGINEER. THE DEVELOPMENT AND UTILIZATION OF THESE MEASURES WILL BE RECORDED AS PART OF THE BMP, KEPT ON SITE, AND AVAILABLE FOR PUBLIC INSPECTION.

- LUMP SUM EROSION CONTROL INCLUDES:
- TEMPORARY SILT FENCE
 - TEMPORARY MULCH
 - TEMPORARY SEEDING AND PROTECTION
 - TEMPORARY DITCH
 - CLEAN SILT FENCE
 - SILT TRAP TYPE C
 - SILT TRAP TYPE A
 - SILT TRAP TYPE B
 - CLEAN SILT TRAP TYPE C
 - CLEAN SILT TRAP TYPE A
 - CLEAN SILT TRAP TYPE B
 - CLEAN TEMPORARY SILT FENCE

FILE NAME: G:\PWORK\BRADLEY_BOTTOMS.D0557394\R00900EC.DGN

USER: ben.hornback
DATE PLOTTED: June 4, 2013

E-SHEET NAME:
MicroStation v8.11.7.443

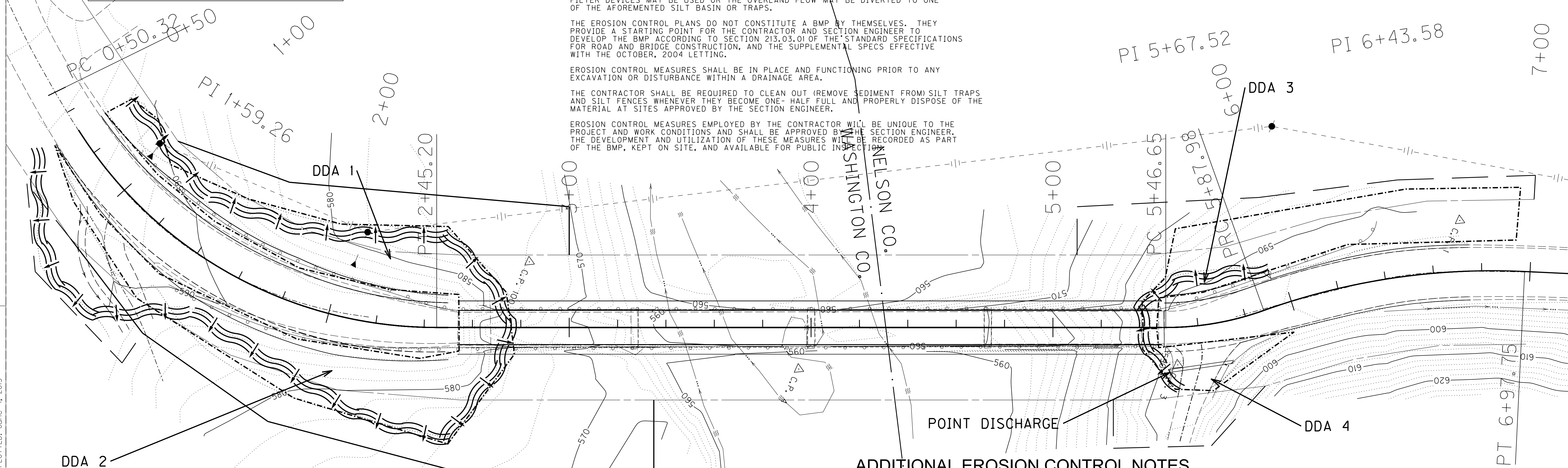

ADDITIONAL EROSION CONTROL NOTES

The contractor will be required by the KDOOW to prepare a sediment and erosion control plan to control non-point source pollution and to successfully implement erosion and sedimentation control during construction. This plan will be enforced throughout the project area.

All streambank disturbances will be promptly seeded with native vegetation at the completion of construction at the particular area.

Temporary erosion protection with mulches and biodegradable fiber mats will be used during construction. DO NOT SPRAY signs will be posted along the proposed riparian right-of-way wherever plantings have been established.

Permanent erosion control features such as seeding and/or planting native trees will be incorporated into the project as construction progresses.

Work in the low-water channel of existing streams will be minimized to the extent possible by limiting construction to the placement of required drainage structures or structure components such as piers, pilings, footings, cofferdams, shaping of fill slopes around bridge abutments and placement of riprap.

The contractor will comply with the sediment and erosion control plan developed for the project during construction and will not initiate construction activities prior to acquisition of all necessary permits, including a Clean Water Act Section 404 permit from the U.S. Army Corps of Engineers, and a Section 401 Water Quality Certification and Stream Construction permit from the Kentucky Division of Water.

Once construction activities have ceased, any disturbed wooded riparian areas of Chaplin River attributed to the construction of the subject project will be replanted. Five tree species will be replanted.

Three-gallon-container-grown-root-production-method (RPM) *Quercus velutina* (black oak), *Q. alba* (white oak) and *Q. rubra* (northern red oak) will be planted on a 15 3/32 x 30 3/32 grid in these areas with 36 3/32 saplings of *Fraxinus americana* (white ash) and *Carya laciniosa* (shellbark hickory) (planted on a 5 3/32 x 5 3/32 grid in the same area. A seed mix containing *Elymus virginicus* (Virginia wild rye) (20%), *Lolium perenne* (perennial rye grass) (10%), *Panicum clandestinum* (deer-tongue grass) (15%), *Chamaecrista fasciculata* (partridge-pea) (15%), *Festuca rubra* (red fescue) (25%), and *Tridens flavus* (purpletop) (15%) will be seeded in the riparian corridor at a rate of two pounds per 1000 square feet to facilitate bank stabilization and erosion prevention. This will also allow for proper regeneration of the riparian corridor with native species, allowing for thermoregulation of the water within the stream, proper physical stabilization of the impacted stream, and aid in providing nutrients via plant matter formacoinvertebrate communities located within the stream. Trees were chosen based on value to wildlife, native vegetation to Nelson County, KY, and preference of soil type.

DISTURBED DRAINAGE AREAS

SECTION	DISTURBED AREA (ACRES)	MAXIMUM SEDIMENT VOLUME (CU FT)
DDA 1	0.08	288
DDA 2	0.12	432
DDA 3	0.08	288
DDA 4	0.02	72

SCALE: 1" = 20'

KY 458
EROSION CONTROL SHEET

EROSION CONTROL NOTES

COUNTY OF	ITEM NO.	SHEET NO.
Nelson Washington	4-1079	R9

REVISED 6-3-13

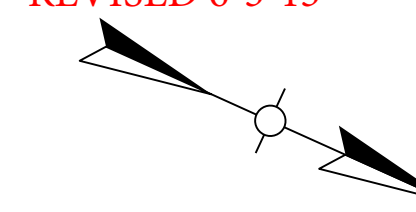

SILT TRAP TYPE A ALTERNATE 1	
SILT TRAP TYPE A ALTERNATE 2	
SILT TRAP TYPE B	
SILT TRAP TYPE C	
SILT FENCE	SF
TEMPORARY SILT DITCH	
DISTURBED DRAINAGE AREA	
OVERLAND SHEET FLOW	
PROPOSED R/W	
PROPOSED EASEMENT	

ALL SILT CONTROL DEVICES SHALL BE SIZED TO RETAIN A VOLUME OF 3,600 CUBIC FEET PER DISTURBED CONTRIBUTING ACRE.

THE CONTRACTOR SHALL CONDUCT HIS OPERATIONS TO MINIMIZE THE AMOUNT OF DISTURBED GROUND DURING EACH PHASE OF CONSTRUCTION. THE CONTRACTOR SHALL COMPUTE THE VOLUME NECESSARY TO CONTROL SEDIMENT DURING EACH PHASE OF CONSTRUCTION. AS WORK PROCEEDS, SILT TRAPS MAY BE ADDED OR REMOVED IN ORDER TO ACHIEVE THE BEST MANAGEMENT PLAN. THE REQUIRED VOLUME AT EACH ADDED SILT TRAP SHALL BE COMPUTED AS UP GRADIENT CONTRIBUTING AREAS ARE DISTURBED OR ARE STABILIZED TO THE SATISFACTION OF THE ENGINEER. THE REQUIRED VOLUME CALCULATION FOR EACH SILT TRAP SHALL BE DETERMINED BY THE CONTRACTOR AND VERIFIED BY THE ENGINEER. THE REQUIRED VOLUME AT EACH SILT TRAP MAY BE REDUCED BY THE FOLLOWING AMOUNTS:

- UP GRADIENT AREAS NOT DISTURBED (ACRES).
- UP GRADIENT AREAS THAT HAVE BEEN RECLAIMED AND PROTECTED BY EROSION CONTROL BLANKET OR OTHER GROUND PROTECTION MATERIAL SUCH AS TEMPORARY MULCH (ACRES).
- THE USE OF TEMPORARY MULCH IS ENCOURAGED.
- UP GRADIENT AREAS THAT HAVE BEEN PROTECTED BY SILT FENCE (ACRES). AREAS PROTECTED BY SILT FENCE SHALL BE COMPUTED AT A MAXIMUM RATE OF 100 SQUARE FOOT PER LINEAR FOOT OF SILT FENCE.
- UP GRADIENT AREAS THAT HAVE BEEN PROTECTED BY SILT TRAPS (ACRES).

THE EROSION CONTROL PLAN SHALL BE ANNOTATED AS THE WORK PROCEEDS BY THE CONTRACTOR TO DETAIL THE SELECTION OF EACH EROSION CONTROL DEVICE USED AND THE VOLUME PROVIDED BY EACH SILT TRAP IN ACCORDANCE WITH THE DOCUMENTATION PROCEDURES ESTABLISHED BY THE DIVISION OF CONSTRUCTION.

IF A SILT BASIN IS NOT USED THEN ONE SILT TRAP TYPE A, ALTERNATE NUMBER 2 OR SILT TRAP TYPE B SHALL ALWAYS BE PLACED AT THE MOST REMOTE DOWNSTREAM COLLECTION POINT PRIOR TO DISCHARGING INTO A BLUE LINE STREAM OR ONTO AN ADJACENT PROPERTY OWNER. WHERE OVERLAND FLOW EXISTS, A SILT FENCE OR OTHER FILTER DEVICES MAY BE USED OR THE OVERLAND FLOW MAY BE DIVERTED TO ONE OF THE AFOREMENTED SILT BASIN OR TRAPS.

THE EROSION CONTROL PLANS DO NOT CONSTITUTE A BMP BY THEMSELVES. THEY PROVIDE A STARTING POINT FOR THE CONTRACTOR AND SECTION ENGINEER TO DEVELOP THE BMP ACCORDING TO SECTION 213.03.01 OF THE STANDARD SPECIFICATIONS FOR ROAD AND BRIDGE CONSTRUCTION, AND THE SUPPLEMENTAL SPECS EFFECTIVE WITH THE OCTOBER, 2004 LETTING.

EROSION CONTROL MEASURES SHALL BE IN PLACE AND FUNCTIONING PRIOR TO ANY EXCAVATION OR DISTURBANCE WITHIN A DRAINAGE AREA.

THE CONTRACTOR SHALL BE REQUIRED TO CLEAN OUT (REMOVE SEDIMENT FROM) SILT TRAPS AND SILT FENCES WHENEVER THEY BECOME ONE-HALF FULL AND PROPERLY DISPOSE OF THE MATERIAL AT SITES APPROVED BY THE SECTION ENGINEER.

EROSION CONTROL MEASURES EMPLOYED BY THE CONTRACTOR WILL BE UNIQUE TO THE PROJECT AND WORK CONDITIONS AND SHALL BE APPROVED BY THE SECTION ENGINEER. THE DEVELOPMENT AND UTILIZATION OF THESE MEASURES WILL BE RECORDED AS PART OF THE BMP, KEPT ON SITE, AND AVAILABLE FOR PUBLIC INSPECTION.

- LUMP SUM EROSION CONTROL INCLUDES:
- TEMPORARY SILT FENCE
 - TEMPORARY MULCH
 - TEMPORARY SEEDING AND PROTECTION
 - TEMPORARY DITCH
 - CLEAN SILT FENCE
 - SILT TRAP TYPE C
 - SILT TRAP TYPE A
 - SILT TRAP TYPE B
 - CLEAN SILT TRAP TYPE C
 - CLEAN SILT TRAP TYPE A
 - CLEAN SILT TRAP TYPE B
 - CLEAN TEMPORARY SILT FENCE

FILE NAME: G:\PWORK\BRADLEY_BOTTOMS.D0557394\R00900EC.DGN

USER: ben.hornback
DATE PLOTTED: June 4, 2013

E-SHEET NAME:
MicroStation v8.11.7.443

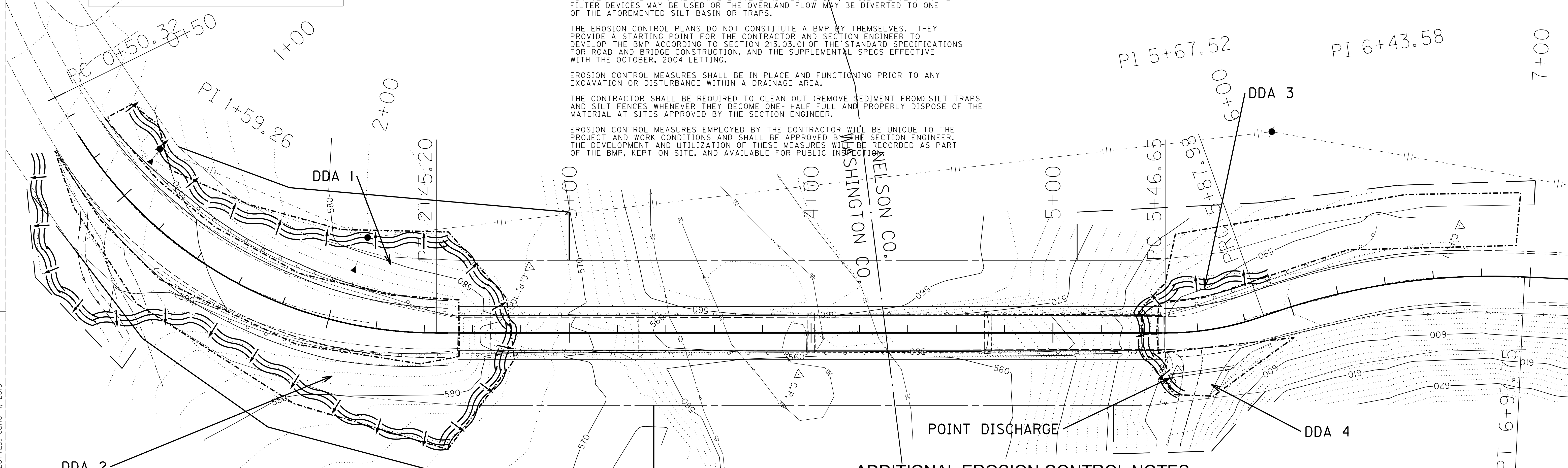

ADDITIONAL EROSION CONTROL NOTES

The contractor will be required by the KDOOW to prepare a sediment and erosion control plan to control non-point source pollution and to successfully implement erosion and sedimentation control during construction. This plan will be enforced throughout the project area.

All streambank disturbances will be promptly seeded with native vegetation at the completion of construction at the particular area.

Temporary erosion protection with mulches and biodegradable fiber mats will be used during construction. DO NOT SPRAY signs will be posted along the proposed riparian right-of-way wherever plantings have been established.

Permanent erosion control features such as seeding and/or planting native trees will be incorporated into the project as construction progresses.

Work in the low-water channel of existing streams will be minimized to the extent possible by limiting construction to the placement of required drainage structures or structure components such as piers, pilings, footings, cofferdams, shaping of fill slopes around bridge abutments and placement of riprap.

The contractor will comply with the sediment and erosion control plan developed for the project during construction and will not initiate construction activities prior to acquisition of all necessary permits, including a Clean Water Act Section 404 permit from the U.S. Army Corps of Engineers, and a Section 401 Water Quality Certification and Stream Construction permit from the Kentucky Division of Water.

Once construction activities have ceased, any disturbed wooded riparian areas of Chaplin River attributed to the construction of the subject project will be replanted. Five tree species will be replanted.

Three-gallon-container-grown-root-production-method (RPM) *Quercus velutina* (black oak), *Q. alba* (white oak) and *Q. rubra* (northern red oak) will be planted on a 15' x 30' grid in these areas with 36% saplings of *Fraxinus americana* (white ash) and *Carya laciniosa* (shellbark hickory) (planted on a 5' x 5' grid in the same area. A seed mix containing *Elymus virginicus* (Virginia wild rye) (20%), *Lolium perenne* (perennial rye grass) (10%), *Panicum clandestinum* (deer-tongue grass) (15%), *Chamaecrista fasciculata* (partridge-pea) (15%), *Festuca rubra* (red fescue) (25%), and *Tridens flavus* (purpletop) (15%) will be seeded in the riparian corridor at a rate of two pounds per 1000 square feet to facilitate bank stabilization and erosion prevention. This will also allow for proper regeneration of the riparian corridor with native species, allowing for thermoregulation of the water within the stream, proper physical stabilization of the impacted stream, and aid in providing nutrients via plant matter formacoinvertebrate communities located within the stream. Trees were chosen based on value to wildlife, native vegetation to Nelson County, KY, and preference of soil type.

SECTION	DISTURBED AREA (ACRES)	MAXIMUM SEDIMENT VOLUME (CU FT)
DDA 1	0.08	288
DDA 2	0.12	432
DDA 3	0.08	288
DDA 4	0.02	72

SCALE: 1"= 20'

KY 458
EROSION CONTROL SHEET

KENTUCKY TRANSPORTATION CABINET COMMUNICATION ALL PROMISES (CAP)

Item No. 04-1079.00 County NELSON Route KY-458 Project Manager kytc\Bradley.Bottoms

CAP #	Date of Promise	Promise made to:	Location of Promise:	CAP Description
1	3/1/13	KY Division of Air Quality	Frankfort	The contractor will be responsible for submitting an NOI (Notice of Intent) to the appropriate Kentucky Division of Air Quality Regional Office at least 10 business days prior to demolition of bridge structure.
2	6/3/13	Joseph Ferguson	Elizabethtown	The contractor must notify Joseph Ferguson, KYTC District Environmental Coordinator, 10 business days (M-F) prior to start of demolition at 270-766-5066 or joseph.ferguson@ky.gov